

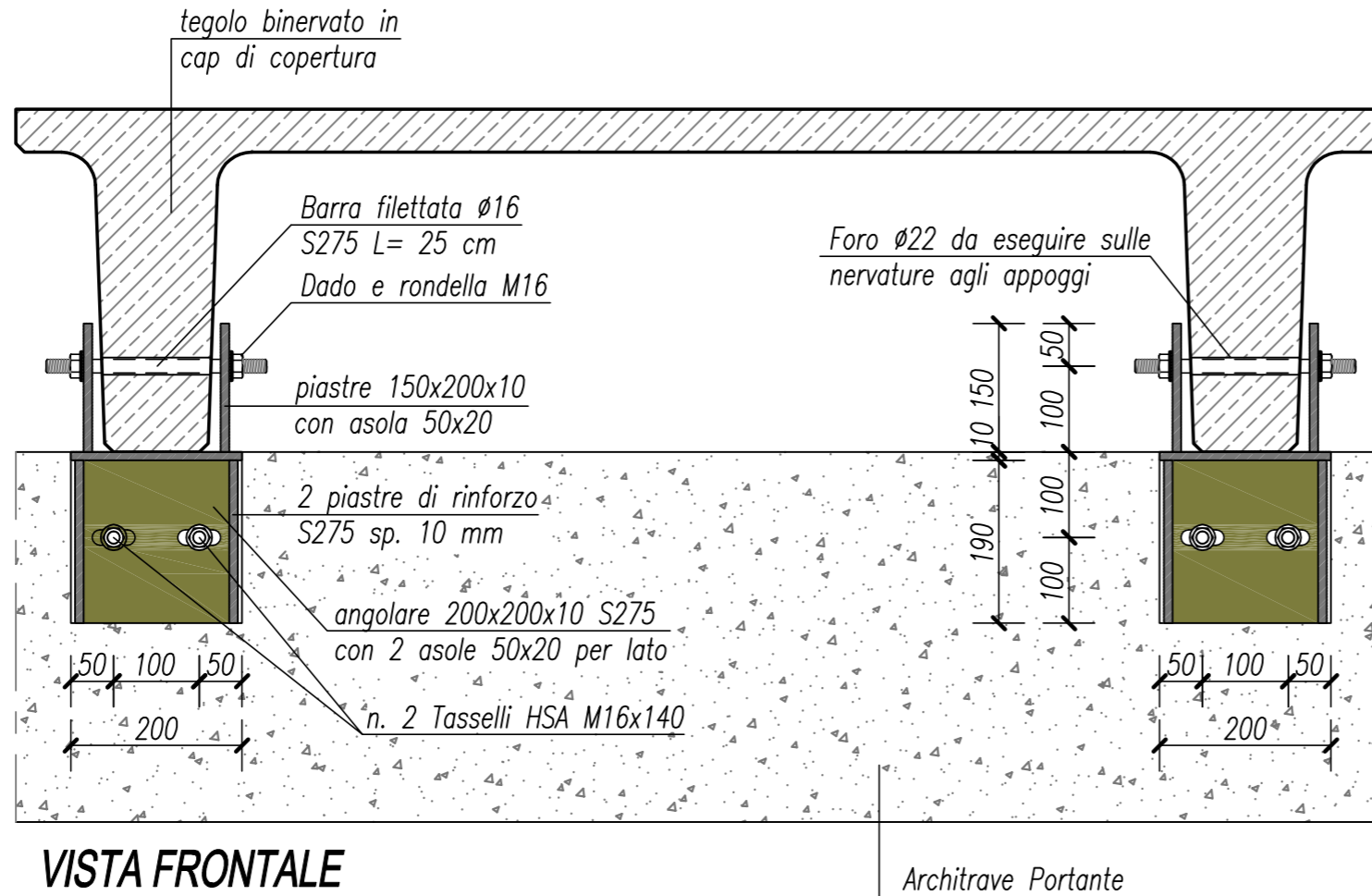

BI engineering

NODO FISSAGGIO TEGOLO BINERVATO ALLA TRAVE PORTANTE



VISTA FRONTALE

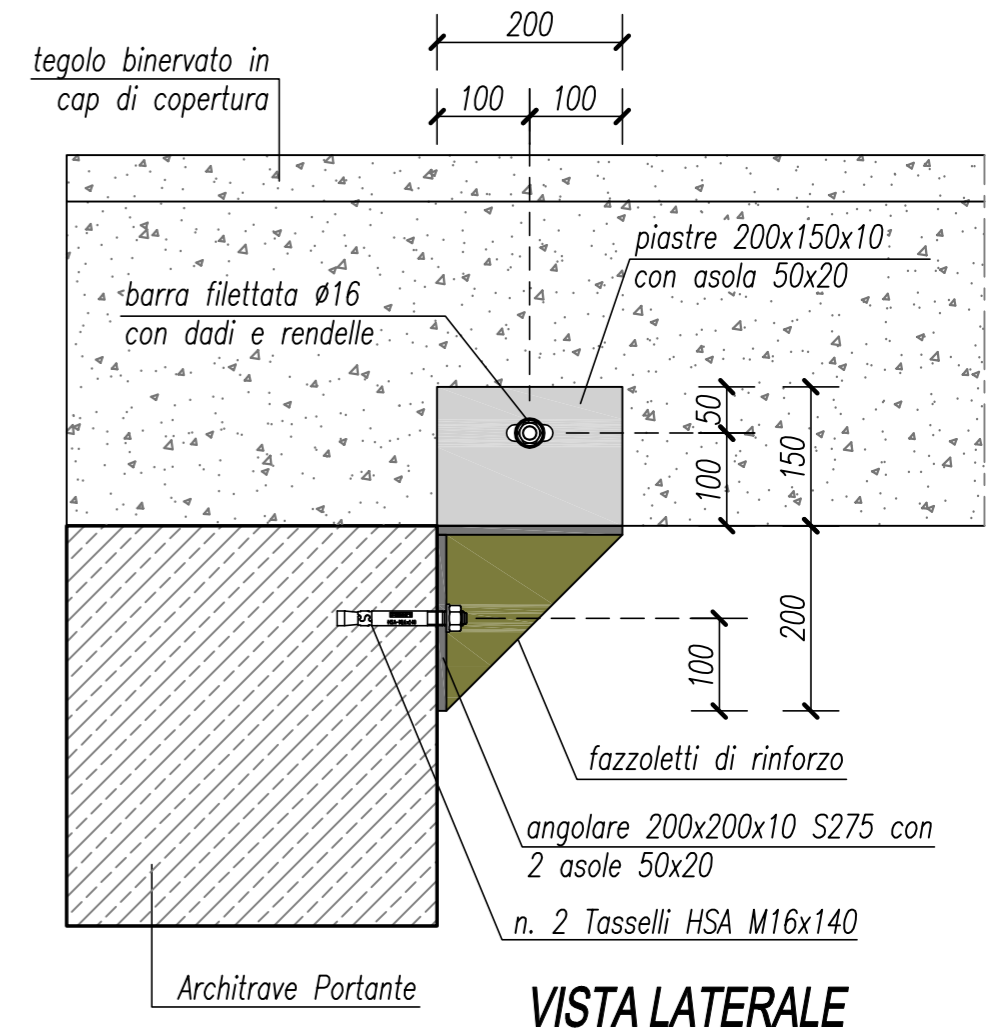

VISTA LATERALE

MATERIALE PER NODO

- 1 Angolare 200x200x10 con 2 asole 50x20
- 2 Tasselli HSA m16x140
- 1 Barra filettata Ø16 S275 L= 25 cm
- 2 Dadi M16
- 2 Rondelle M16

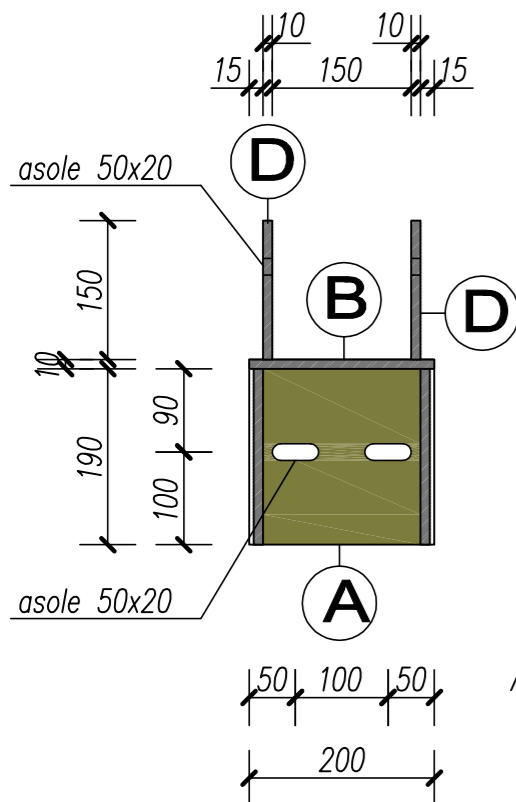

ACCIAIO TIPO S275

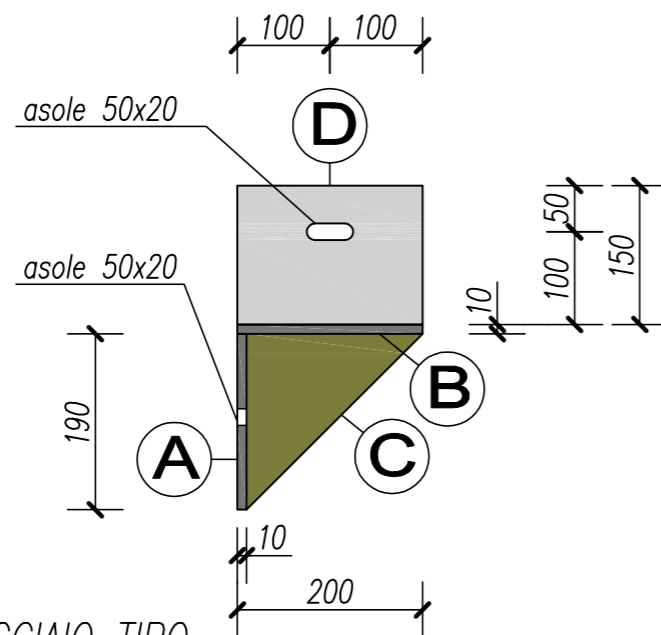

Rondelle M16

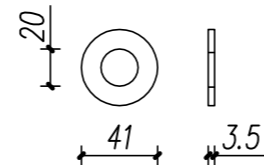

Dadi M16

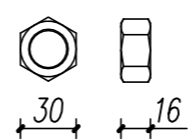

Barre in acciaio liscio M16 S235 L= 30 cm filettate alle estremità

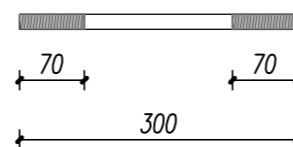

Tasselli HSA M16x140

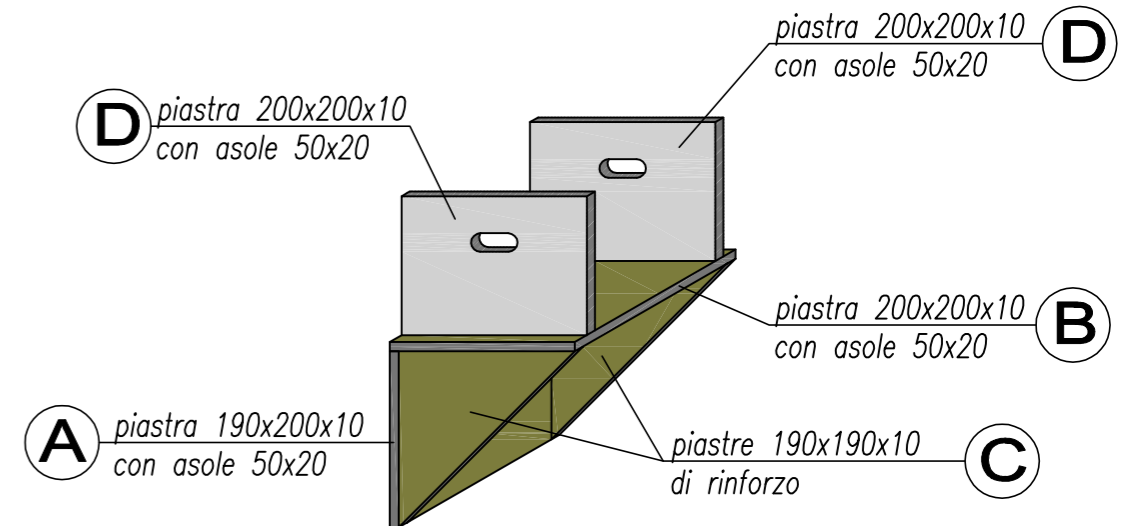

FERRAMENTA A CORREDO